

MAX LEVY AUTOGRAPH, INC. PROPRIETARY

THIS DRAWING CONTAINS CONFIDENTIAL PROPRIETARY INFORMATION THAT IS MAX LEVY AUTOGRAPH, INC. PROPERTY. DO NOT DISCLOSE TO NOR DUPLICATE FOR OTHERS EXCEPT AS AUTHORIZED BY MAX LEVY AUTOGRAPH, INC.

DATE	SYM	REVISION RECORD	AUTH	DR	CK

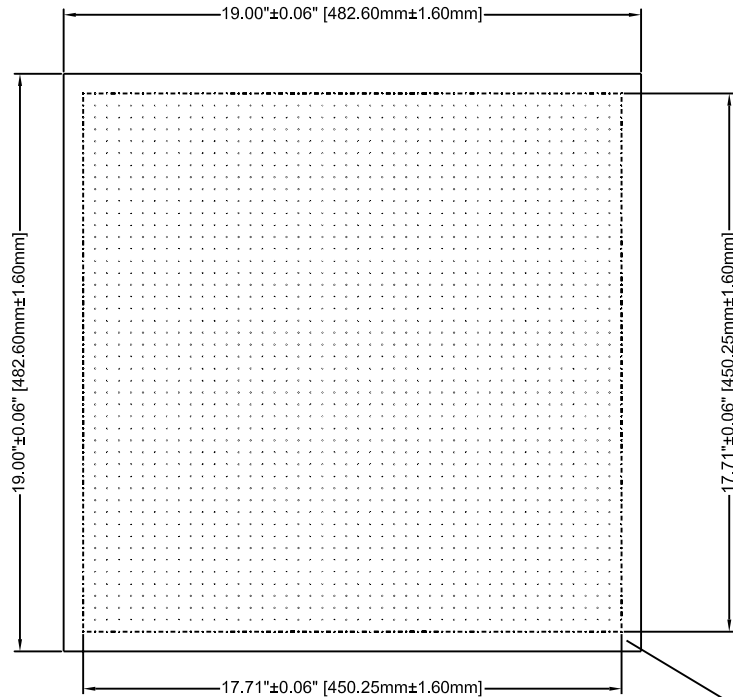

NOTES:

- ASSEMBLY TO BE PATTERN BONDED BETWEEN TWO PIECES OF 1/8" PHOTO QUALITY SODA LIME GLASS. TOTAL THICKNESS OF 1/4".
- FLATNESS: TOP SURFACE OF SODA LIME GLASS TO BE 0.004"
- BEVEL: 0.020" - 0.060"
- SCRATCH / DIG: 20 / 10 INSIDE ACTIVE AREA, 60 / 40 OUTSIDE
- COATING: LOW REFLECTION CHROME LOOKING THROUGH GLASS. CHROMIUM OXIDE COATING TO PROVIDE LOW REFLECTION LOOKING AT THE PATTERN WITH REFLECTIVITY LESS THAN FIVE PERCENT (<5%) FOR LIGHT WAVELENGTH 550 nm (CENTER OF VISIBLE). BACKGROUND DIFUSE WHITE.
- PATTERN:
 LINEWIDTH: 0.010" ±0.0003"
 DOT OUTER DIA.: 0.25MM ±0.0076MM (0.0394" ±0.0003")
 DOT SPACING, CENTER TO CENTER: 10.0MM ±0.0025MM (0.3940" ±0.0001")
 CENTERED ON SUBSTRATE
- OVERALL ACCURACY: ±0.0003"

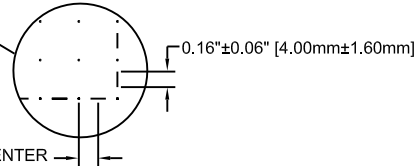

0.20"±0.02" [5.00mm±1.60mm] CENTER TO CENTER

MLO PART NO.: FA033 SHEET 3 OF 3 ONLINE CATALOG RD2055

TOLERANCES (EXCEPT AS NOTED)		MAX LEVY AUTOGRAPH	
DECIMAL .XXX= +/-0.005 .XX= +/-0.015 .X= +/-0.030	MATERIAL SEE NOTES	SCALE NONE	DRAWN BY TEN
FRACTIONAL +/-0.030	TITLE DOT GRID -LOW REFLECTION CHROME/WHITE GLASS ASSEMBLY		
ANGULAR +/-0.5Deg.	DATE 11/12/01	DRAWING NUMBER 300MLA0064-005	