

|  |  |      |     |                 |      |    |    |  |
|--|--|------|-----|-----------------|------|----|----|--|
| MAX LEVY AUTOGRAPH, INC. PROPRIETARY   |  | DATE | SYM | REVISION RECORD | AUTH | DR | CK |  |
| THIS DRAWING CONTAINS CONFIDENTIAL PROPRIETARY INFORMATION THAT IS MAX LEVY AUTOGRAPH, INC. PROPERTY. DO NOT DISCLOSE TO NOR DUPLICATE FOR OTHERS EXCEPT AS AUTHORIZED BY MAX LEVY AUTOGRAPH, INC. |  |      |     |                 |      |    |    |  |
|  |  |      |     |                 |      |    |    |  |
|  |  |      |     |                 |      |    |    |  |
|  |  |      |     |                 |      |    |    |  |
|  |  |      |     |                 |      |    |    |  |

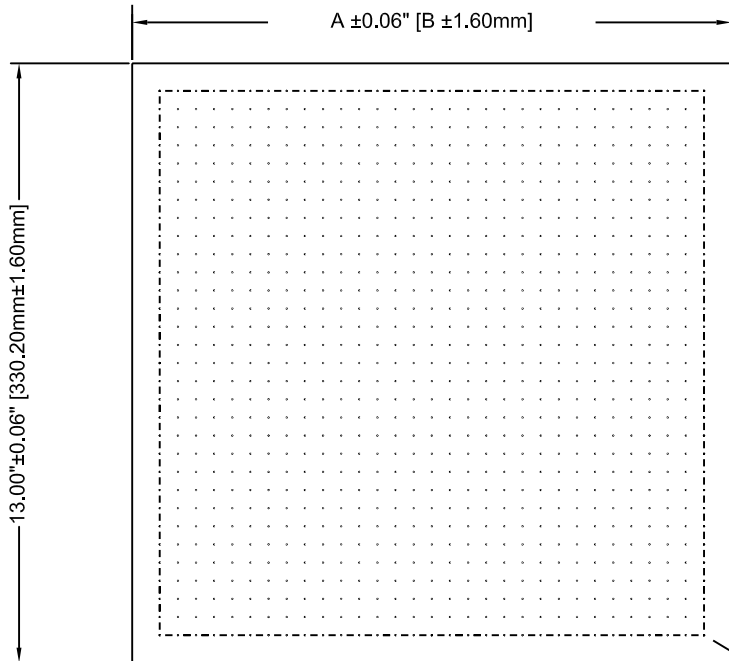

NOTES:

- ASSEMBLY TO BE PATTERN BONDED BETWEEN TWO PIECES OF 1/8" PHOTO QUALITY SODA LIME GLASS. TOTAL THICKNESS OF 1/4".
- FLATNESS: TOP SURFACE OF SODA LIME GLASS TO BE 0.004"
- BEVEL: 0.020" - 0.060"
- SCRATCH / DIG: 20 / 10 INSIDE ACTIVE AREA, 60 / 40 OUTSIDE
- COATING: LOW REFLECTION CHROME LOOKING THROUGH GLASS. CHROMIUM OXIDE COATING TO PROVIDE LOW REFLECTION LOOKING AT THE PATTERN WITH REFLECTIVITY LESS THAN FIVE PERCENT (<5%) FOR LIGHT WAVELENGTH 550 nm (CENTER OF VISIBLE). BACKGROUND DIFFUSE WHITE.
- PATTERN:  
 LINEWIDTH: 0.010" ±0.0003"  
 DOT OUTER DIA.: 0.25MM ±0076MM (0.0394" ±0.0003")  
 DOT SPACING, CENTER TO CENTER: 10.0MM ±0.0025MM (0.3940" ±0.0001")  
 CENTERED ON SUBSTRATE

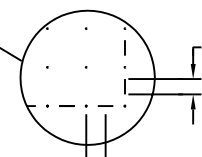

0.20"±0.02" [5.00mm±1.60mm] CENTER TO CENTER

ONLINE CATALOG RD2055

|  |                        |   |                 |
|--|------------------------|---|-----------------|
| TOLERANCES (EXCEPT AS NOTED)                               |                        | <b>MAX LEVY AUTOGRAPH</b>                                     |                 |
| DECIMAL<br>.XXX= +/-0.005<br>.XX= +/-0.015<br>.X= +/-0.030 | FRACTIONAL<br>+/-0.030 |   |                 |
| MATERIAL<br>SEE NOTES                                      |                        | SCALE<br>NOTES  | DRAWN BY<br>TEN |
| APPROVED BY  |                        | TITLE<br>DOT GRID -LOW REFLECTION CHROME/WHITE GLASS ASSEMBLY |                 |
| ANGULAR<br>+/-0.5Deg.                                      | DATE<br>11/12/01       | DRAWING NUMBER<br><b>300MLA0064-00X</b>                       |                 |

| STOCK ITEM NUMBER | "A" DIMENSION | "B" DIMENSION | ACTIVE PATTERN AREA                | OVERALL ACCURACY | DRAWING NUMBER |
|-------------------|---------------|---------------|------------------------------------|------------------|----------------|
| FA029             | 13.00"        | 330.20mm      | 300.25 X 300.25MM (11.81 X 11.81") | ±0.0003"         | -003           |
| FA031             | 19.00"        | 482.60mm      | 300.25 X 450.25MM (11.81 X 17.71") | ±0.0003"         | -004           |